



10-S & 12-S PARTS MANUAL

Ashland Industries Inc.
Hwy. 13 South
P.O. Box 717
Ashland, WI. 54806
877-634-4622 Toll Free - phone
715-682-4622 phone
715-682-9717 fax
www.ashlandind.com



BOWL ASSEMBLY

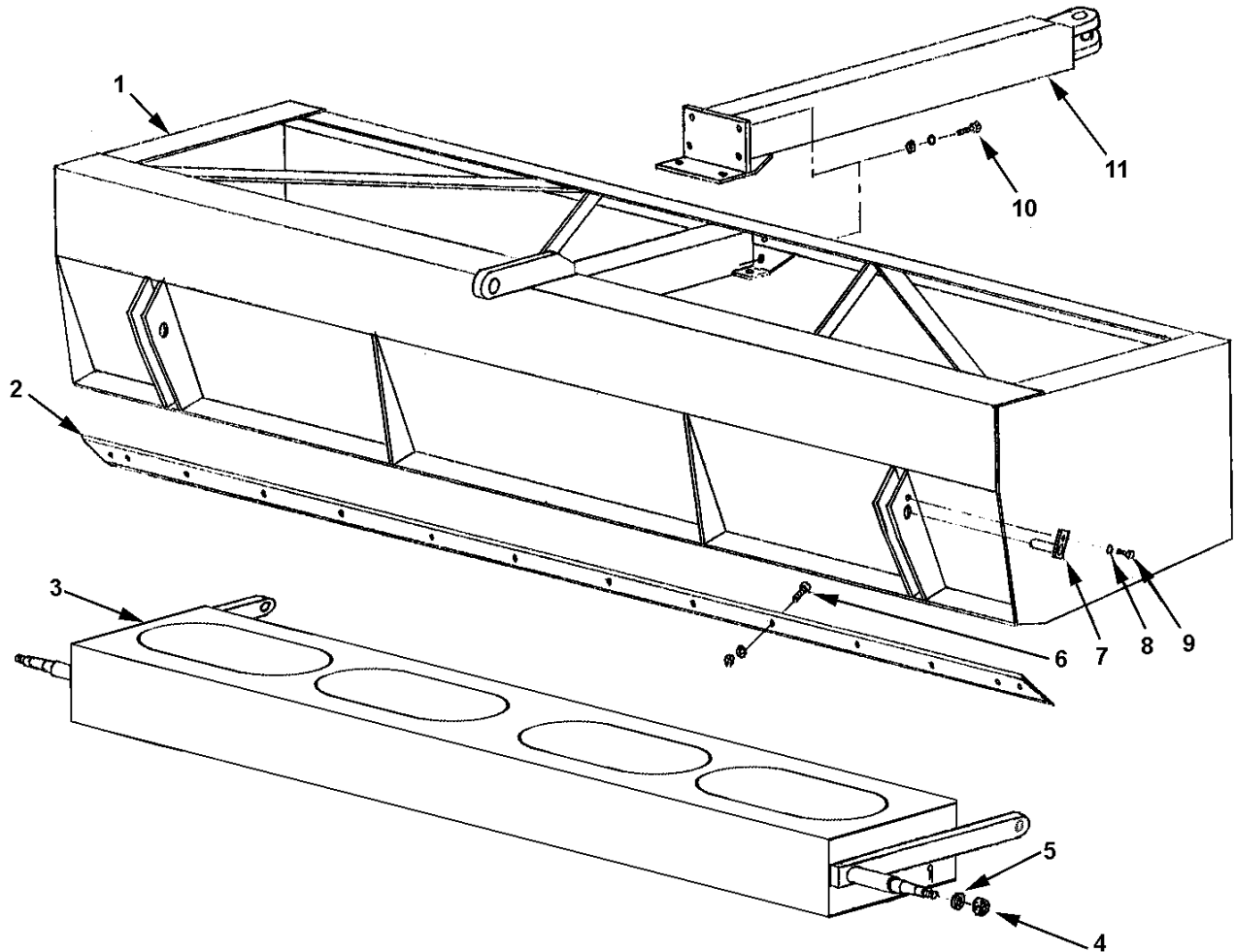

10s12sbowlnew

MODEL 10S s/n 15168 & up
MODEL 12S

KEY NO.	PART NO.	DESCRIPTION
1	A10S10	Bowl Assembly, 10'
	A12S12	Bowl Assembly, 12'
2	A10S02	Cutting edge, 1/2" x 6" x 10'
	A12S02	Cutting edge, 1/2" x 6" x 12'
3	A10S11	Axle & weight box assembly
4		Nut, 7/8" NF castellated
5	A2239	Washer, special 7/8" flat
6		Plow bolt, 1/2" x 1-3/4" w/ nut (10S requires 12, 12S requires 14)
7	A4505	Pin, 1-1/4" x 2-3/8" long
8		Lockwasher, 1/2"
9		Bolt, 1/2" NC x 1" long
10		Bolt, 3/4" NC x 2" long w/ nut & lockwasher
11	A10S12	Pole

WHEEL & HUB ASSEMBLY

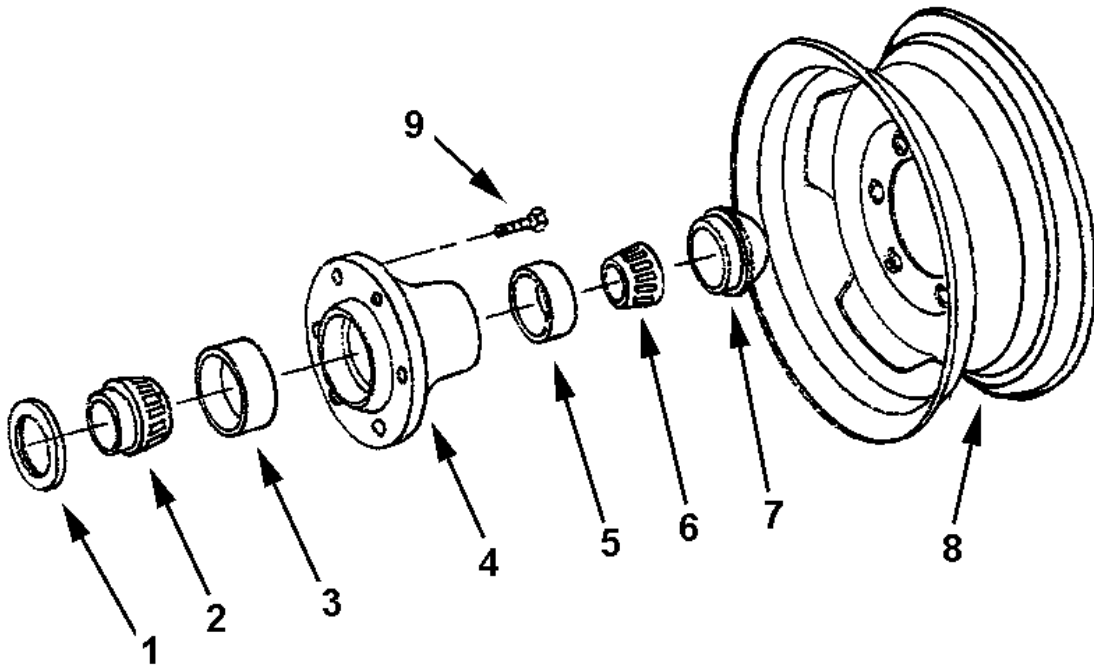

wheel

KEY NO.	PART NO.	DESCRIPTION
1	A2229	Grease seal
2	A2230	Bearing cone, inner
3	A2231	Bearing cup, inner
4	A2232	Hub, less bearings
5	A2233	Bearing cup, outer
6	A2234	Bearing cone, outer
7	A2235	Hub cap
8	A3319	Wheel, 6" x 15" (standard)
	A2237	Wheel, 6" x 14" (optional)
9	A2236	Wheel bolt, 1/2" NF