



10-S & 12-S PARTS MANUAL

Version: 10S-12S Jan. 18, 2002

Ashland Industries Inc.
Hwy. 13 South
P.O. Box 717
Ashland, WI. 54806
877-634-4622 Toll Free - phone
715-682-4622 phone
715-682-9717 fax
www.ashlandind.com



MODEL 10-S AND 12-S SCRAPER

HOW TO ORDER PARTS:

Be sure to state MODEL and SERIAL NO. of machine, PARTS NO., DESCRIPTION, and QUANTITY wanted.

Unless this is done, we cannot provide prompt service or assure shipment of the correct parts.

INDEX

PAGE NO.

1. Bowl Assembly
2. Wheel & Hub Assembly

BOWL ASSEMBLY

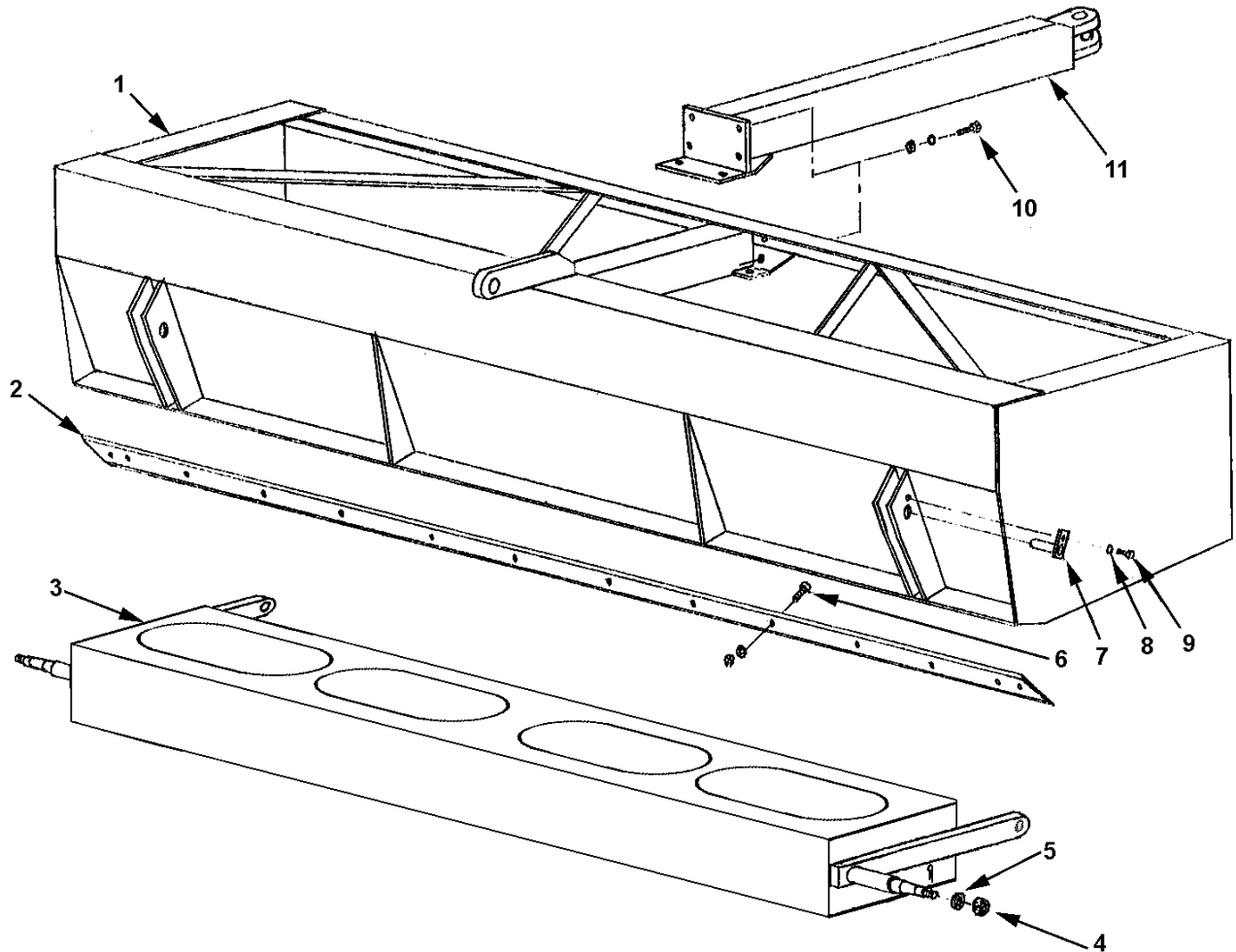

10s12sbowlnew

MODEL 10S s/n 15168 & up
MODEL 12S

KEY NO.	PART NO.	DESCRIPTION
1	A10S10	Bowl Assembly, 10'
	A12S12	Bowl Assembly, 12'
2	A10S02	Cutting edge, 1/2" x 6" x 10'
	A12S02	Cutting edge, 1/2" x 6" x 12'
3	A10S11	Axle & weight box assembly
4		Nut, 7/8" NF castellated
5	A2239	Washer, special 7/8" flat
6		Plow bolt, 1/2" x 1-3/4" w/ nut (10S requires 12, 12S requires 14)
7	A4505	Pin, 1-1/4" x 2-3/8" long
8		Lockwasher, 1/2"
9		Bolt, 1/2" NC x 1" long
10		Bolt, 3/4" NC x 2" long w/ nut & lockwasher
11	A10S12	Pole

WHEEL & HUB ASSEMBLY

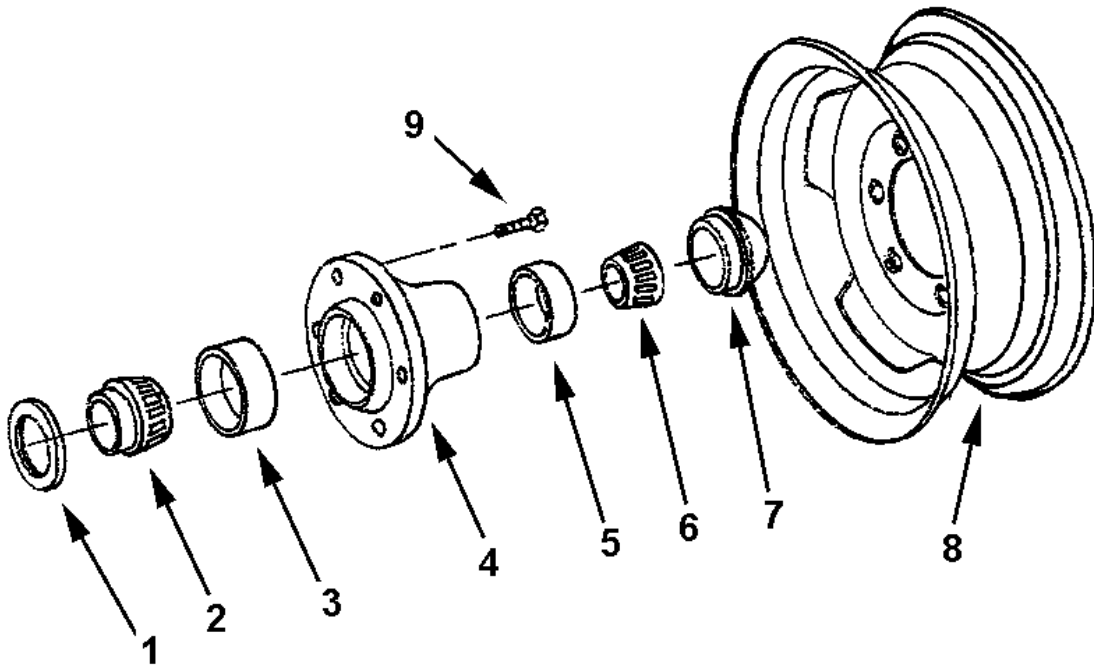

wheel

KEY NO.	PART NO.	DESCRIPTION
1	A2229	Grease seal
2	A2230	Bearing cone, inner
3	A2231	Bearing cup, inner
4	A2232	Hub, less bearings
5	A2233	Bearing cup, outer
6	A2234	Bearing cone, outer
7	A2235	Hub cap
8	A3319	Wheel, 6" x 15" (standard)
	A2237	Wheel, 6" x 14" (optional)
9	A2236	Wheel bolt, 1/2" NF