



BUCHLI MASTER PARTS BOOK

L-10 Land Leveler

ver 12-02

Ashland Industries Inc.
1115 Rail Drive
P.O. Box 717
Ashland, WI. 54806
Ph: 877-634-4622 *Toll Free*
Ph: 715-682-4622
Fx: 715-682-9717
www.ashlandind.com



INDEX PAGE

L-10 Land Plane

How to order parts:

Be sure to state MODEL and SERIAL NO. of machine, PARTS NO., DESCRIPTION, and QUANTITY wanted.

Unless this is done, we cannot give you prompt service or send the correct parts.

I N D E X

Page No.

3 & 4	Illustration & Parts List - Front Frame Section, and Front Dolly & Hitch Ass'y
5 & 6	Illustration & Parts List - Rear Frame Section , Moldboard Ass'y & Braces
7 & 8	Illustration & Parts List - Rear Axle & Depth Gauge
9	Illustration & Parts List - Front and Rear Wheel, Hub, and Bearing Ass'y

FRONT FRAME SECTION & DOLLY ASSEMBLY

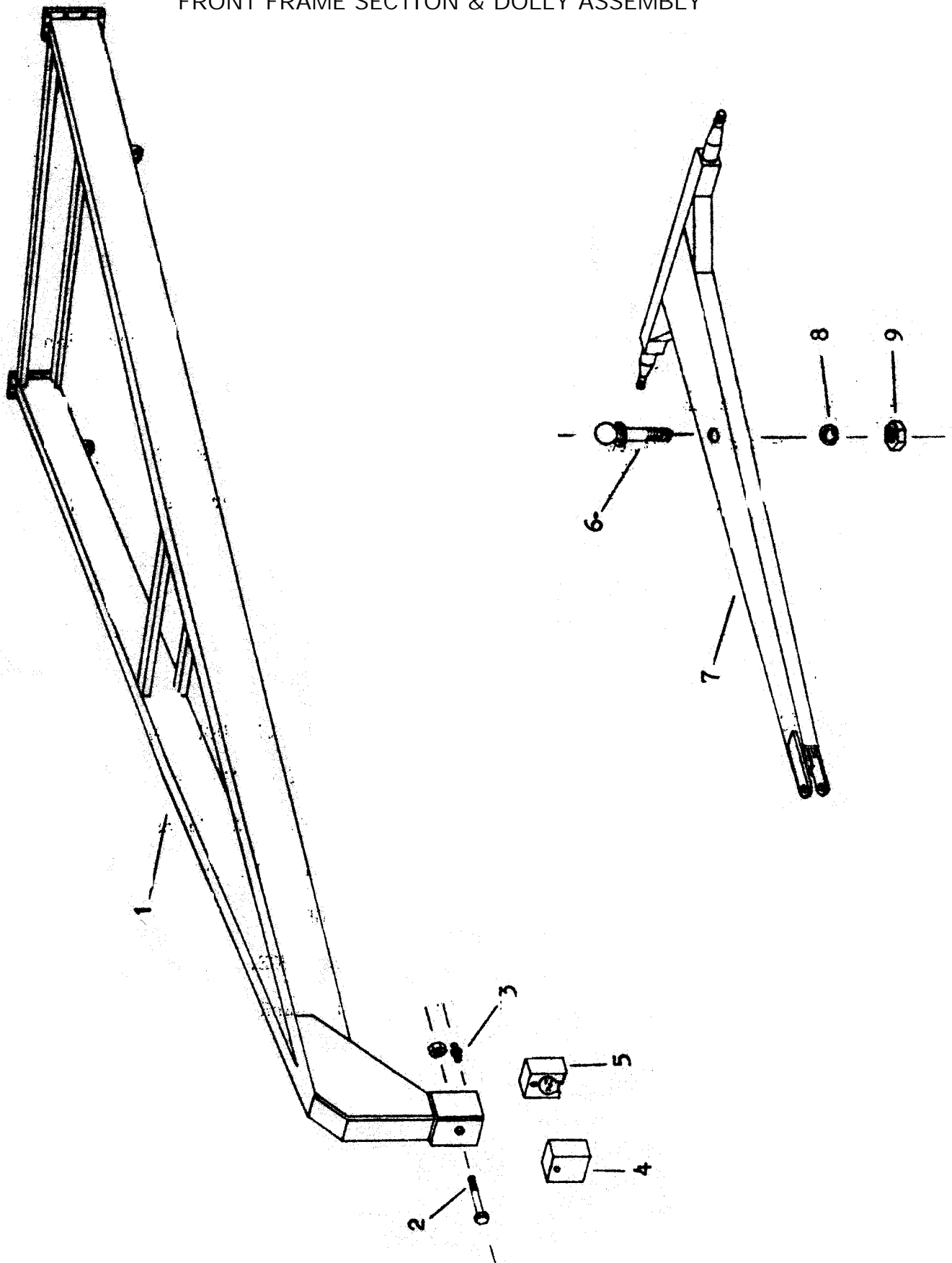

PARTS LIST

FRONT FRAME SECTION, FRONT DOLLY & HITCH ASS'Y

L-10 LAND LEVELER

Key No.	Part No.	Description
1	L-101	Front frame section
2		Bolt, 5/8 x 5-1/2 w/nut & LW
3	3002	Zerk, 1/8 NPT long shank
4	215A	Cast socket (front half)
5	215	Cast socket (rear half)
6	216	Ball swivel, 1-1/4 NF thread
7	L-92A	Pole and axle
8		Lockwasher, 1-1/4
9		Nut, 1-1/4 NF

REAR FRAME SECTION, CUTTING EDGE, BRACES & MOLDBOARD ASS'Y

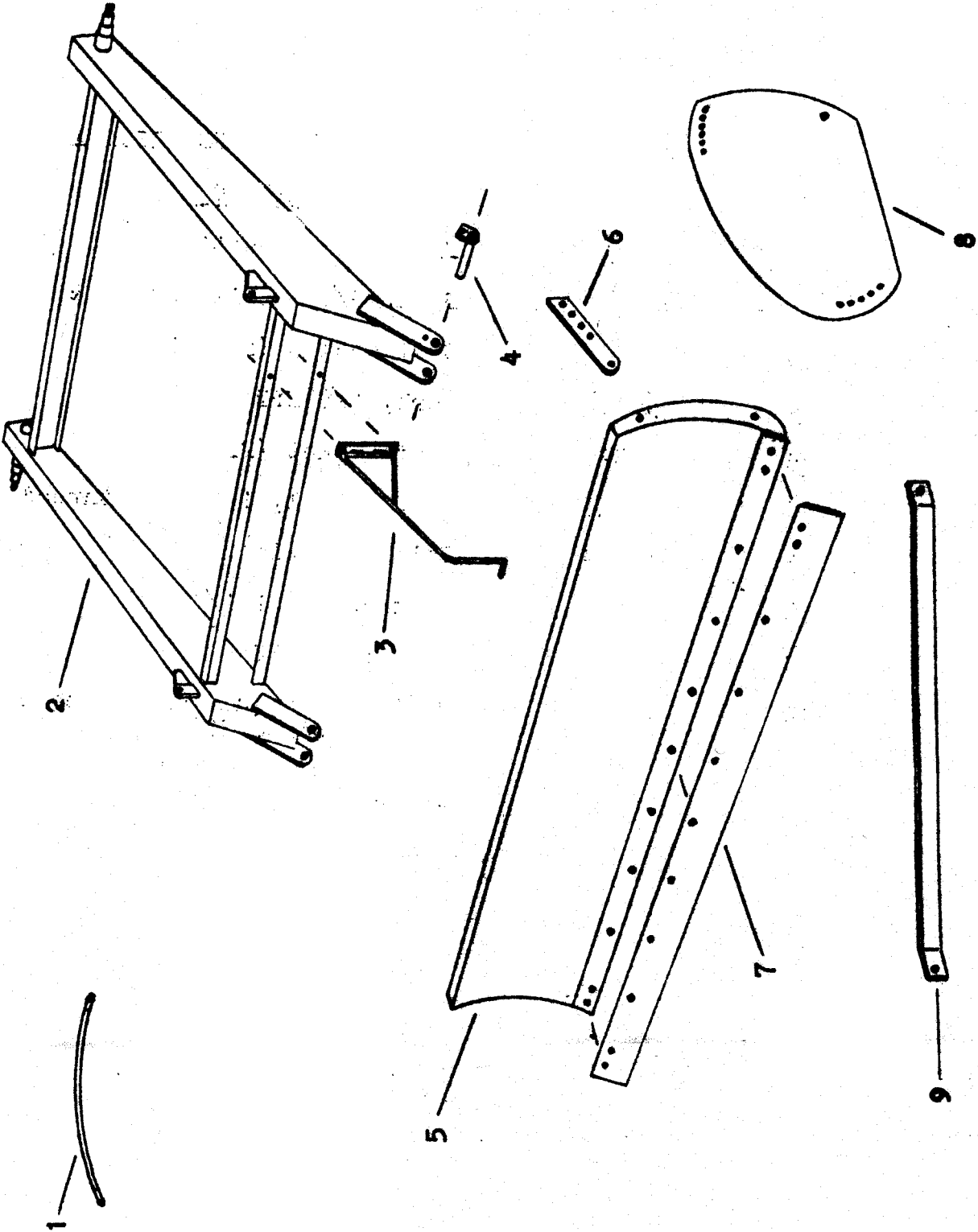

PARTS LIST

REAR FRAME SECTION, CUTTING EDGE, BRACES & MOLDBOARD ASS'Y

L-10 LAND LEVELER

Key No.	Part No.	Description
1	L-103	Hydraulic hose, 1/2 x 18 (at joint of front and rear sections)
2	L-104	Moldboard ass'y (uses 3/4" x 3" bolts to connect to rear frame)
3	L-105	Cutting edge, (10') uses 1/2" x 1-1/2" plow bolts
4	L-106	Rear frame section (uses 5/8" x 1-1/2" bolts to join front)
5	L-107	Tilt bracket (uses 1/2" x 2-1/2" bolts)
6	L-108	Moldboard center brace (uses 3/4" x 2-1/4" bolt at moldboard & 5/8" x 2-1/2" bolt at rear frame)
7	L-109	End plate brace (uses 5/8" x 2" bolt at frame & 5/8" x 1-1/2" at end plate)
8	L-1010	Moldboard end plate (right & left same) (uses 3/4" x 2" bolt at bottom rear & 1/2" x 1-1/2" bolt at top)

ILLUSTRATION - REAR AXLE ASS'Y, HYD HOSE, & DEPTH GAUGE

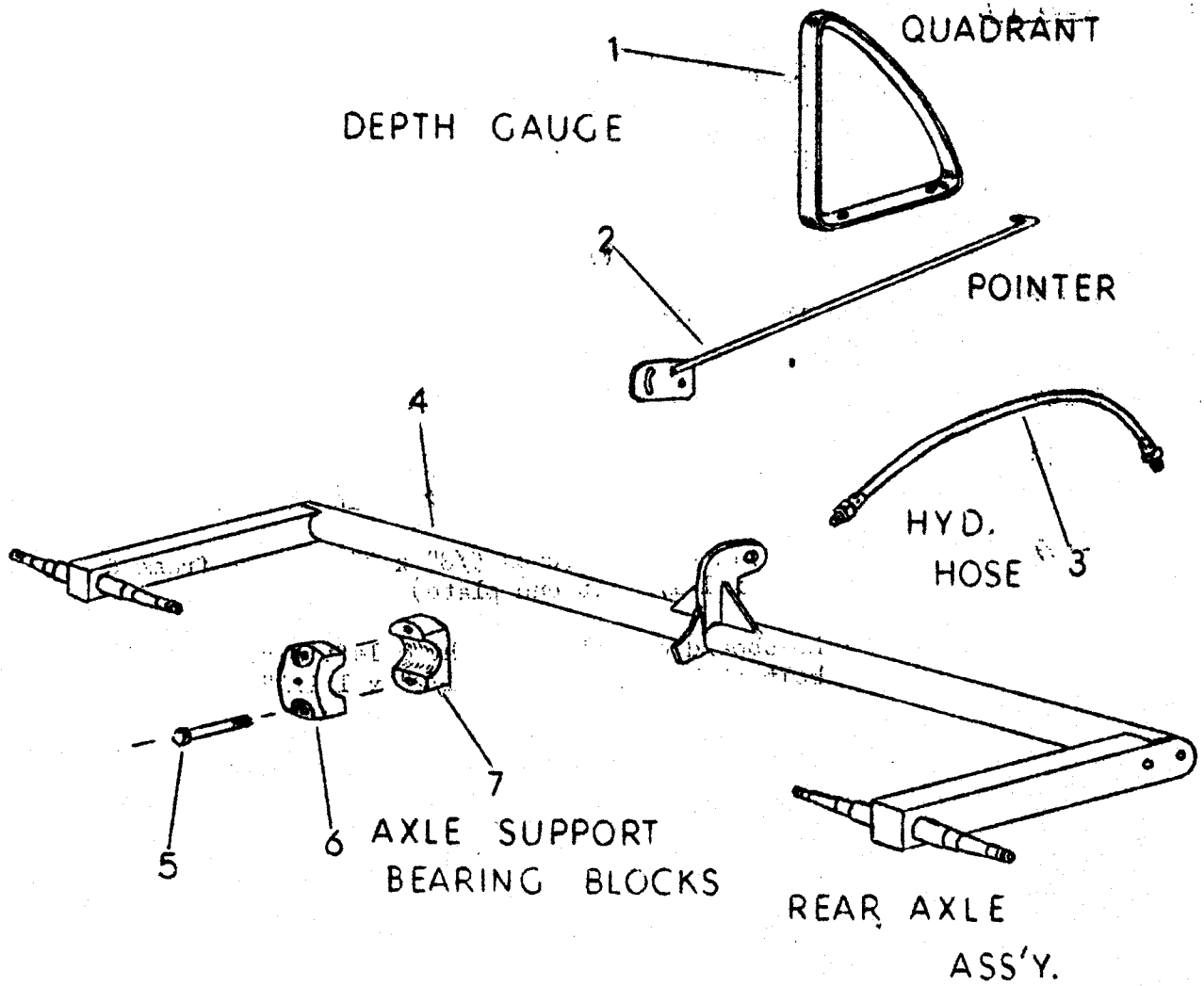

PARTS LIST

REAR AXLE ASS'Y AND DEPTH GAUGE

L-10 LAND LEVELER

Key No.	Part No.	Description
1	L-1011	Depth gauge quadrant (uses 3/8" x 1" cap screw NC)
2	L-1012	Depth gauge pointer (uses 3/8" x 1" cap screw NC)
3	L-1013	Hydraulic hose, 1/2" x 28" (oil line to cyl.)
4	L-1014	Rear axle and spindle ass'y
5		Bolt, 5/8" x 4-1/2" NC w/nut, F & LW
6	L-1015-C	Bearing block (cap) uses 1/8" NFT zerk
7	L-1016-B	Bearing block (base)

ILLUSTRATION - WHEEL, HUB & SPINDLE ASSEMBLY

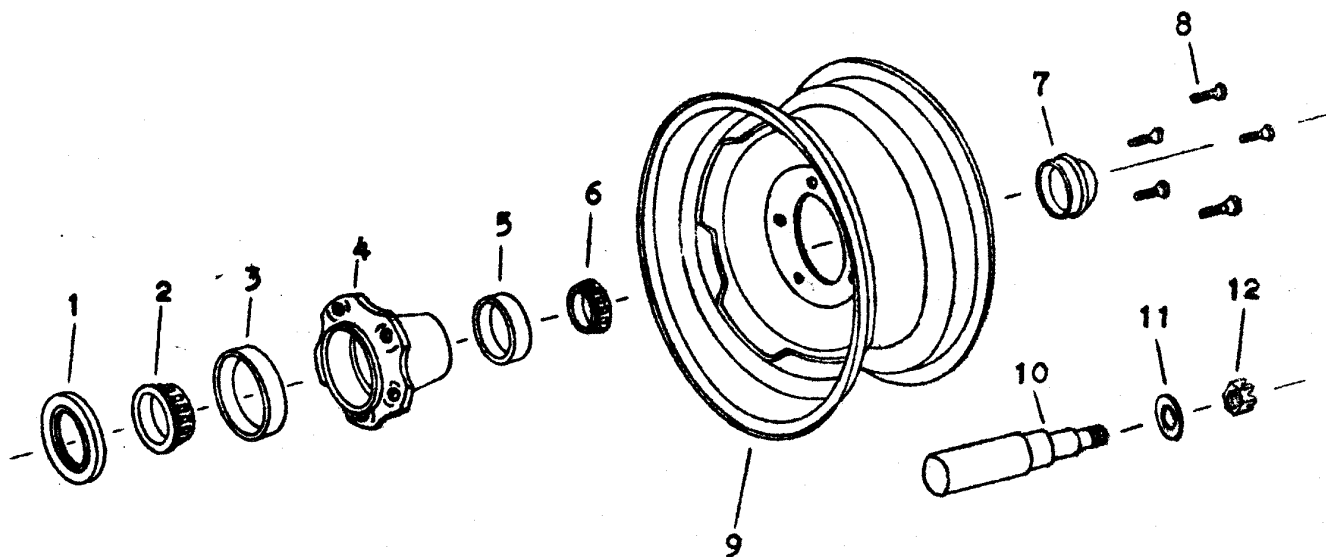

PARTS LIST

Key No.	Part No.	Description
1	AFS-2130	Grease seal
2	14136A	Bearing cone, inner
3	14276	Bearing cup, inner
4	Q502	Hub, less bearings
5	09195	Bearing cup, outer
6	09067	Bearing cone, outer
7	FS-8432	Hub cap
8	MSK-523-1	Wheel bolt
9	C-13751	Wheel, 14" x 5"
10	FS-12594	Spindle
11		Washer, 3/4 flat
12		Nut, 3/4 NF castellated